

# STExCP8-PB Push Button Call Point

The STExCP8-PB latching, dual action push button manual call point, featuring 316L stainless steel enclosures, is designed for the harshest of environments.

Approved for Zone 1 and 2 hazardous areas for fire and gas alarm systems plus emergency shutdown and process control applications. Available with standard DIN rail terminals or the innovative E2S termination board providing dedicated connections for field installed EOL and/or series devices. SIL 2 compliant to IEC 61508 (2010). DNV type approved for exposed locations.

## Features

- Robust corrosion proof 316L stainless steel enclosure
- Epoxy powder coat paint finish
- Alternative housing colours are available to meet specific requirements
- Ingress protection IP66
- Single or double switch
- Optional equipment tags and duty labels
- 2 x 316 Stainless steel stopping plugs included
- 3 x M20 cable entries
- Stainless steel fasteners
- DNV type approved IEC 60945 & DNVGL-CG-0339

## Approvals

- IECEx certificate: IECEx ULD 15.0018X,  
IEC 60079-0:2011 Edition: 6.0,  
IEC 60079-1:2014-06 Edition: 7.0
- ATEX certificate: DEMKO 15 ATEX 1589X,  
EN 60079-0:2012+A11:2013  
EN 60079-1:2014
- TR-CU Ex EAC certificate: RU C-GB.AA71.B.00109
- SIL 2 compliant to IEC 61508 (2010)

## Coding

- Ex db IIC T6 Gb Ta. -55°C to +70°C (Single switch)
- Ex db IIC T5 Gb Ta. -55°C to +70°C (Dual switch)
- Ex db IIC T6 Gb Ta. -55°C to +60°C (Dual switch)



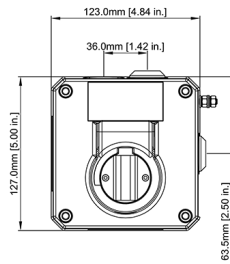
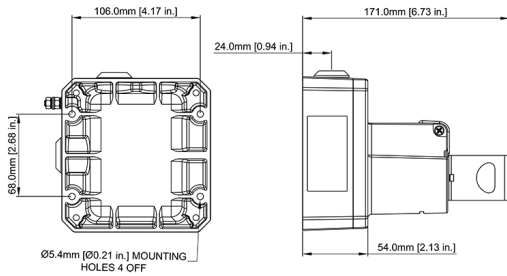
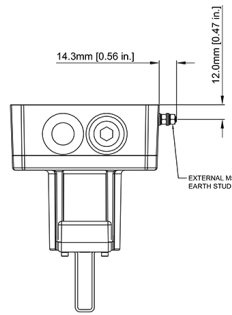
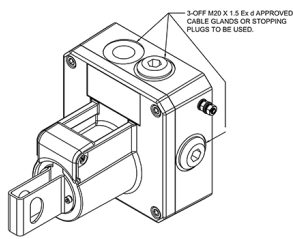

## Specification

Version: STExCP8PB

Coding: Ex db IIC T6 Gb Ta. -55°C to +70°C (Single switch)  
Ex db IIC T5 Gb Ta. -55°C to +70°C (Dual switch)  
Ex db IIC T6 Gb Ta. -55°C to +60°C (Dual switch)

Ingress protection: EN/IEC 60529 - IP66

Enclosure matl: 316L Stainless Steel

Colour: RAL3000 Red (others available on request)

Cable entries: 2 x M20x1.5 top and  
1 x M20x1.5 side.  
Back box can be rotated to give  
2 x bottom and 1 x side entries

Stopping plugs: 2 x 316 Stainless Steel plugs as standard  
Brass and Nickel plated plugs optional

Terminals: DIN rail 8 x 2.5mm<sup>2</sup> SAK2.5 or  
Termination board featuring 6 x 2.5mm<sup>2</sup> terminals  
plus 4 x dedicated EOL & Series terminals

Earth: External M5 earth connection

Weight: 4.6Kg/10.14lbs

Voltage Range: Max input Limitations for EOL / Series  
Current: Resistors:

250Vac Max 5.0A max not permitted

48Vdc Max 1.0A max min. 2.2kOhm

24Vdc Max 3.0A max min. 470 Ohm

EOL and Series Diode Values:

xxx: Zener value: Max. current supply permitted

3V3 3.3V Diode 230mA

4V7 4.7V Diode 162mA

5V1 5.1V Diode 149mA

5V6 5.6V Diode 136mA

6V2 6.2V Diode 122mA

6V8 6.8V Diode 112mA

10V 10V Diode 76mA

12V 12V Diode 63mA

## Part Codes

Version:	Part code:	Description:
Product type:	STExCP8PB	Dual action latching push button with manual reset
Switch Type: [s]	S	SPCO/SPDT
	D	DPCO/DPDT
Cable Entry Type: [e]	A	3 x M20x1.5mm
	B	2 x 1/2" NPT - adaptors
	C	2 x 3/4" NPT - adaptors
	D	2 x M25x1.5mm - adaptors
	E	1 x 1/2" NPT - adaptor
	F	1 x 3/4" NPT - adaptor
	G	1 x M25x1.5mm - adaptor
	H	3 x 1/2" NPT - adaptors
	I	3 x 3/4" NPT - adaptors
	J	3 x M25x1.5mm - adaptors
Stopping plug material: [m]	S	Stainless Steel [Default]
Terminals: [t]	D	DIN Rail 8 x SAK2.5
	P	Termination board: 6 x 2.5mm <sup>2</sup> terminals plus 4 x EOL & Series terminals
Lift flap: [l]	N	Lift flap not available for -PB version
Duty label [d]:	1	No Duty label, no Equip. tag
	2	Duty label St/St
	3	Duty label St/St + Equip. tag
	4	Duty label Metalised Polyester
	5	Duty label M. Poly. + Equip. tag
	6	Equip. tag only
Product version: [v]A1		IECEX & ATEX & CUTR Ex EAC & DNV Type Approved
Enclosure colour: [x]	R, B, N, Y, V, S, K	Red, Blue, Green, Yellow Red/White, Yellow/Black, Black
E.O.L.Module: [Exxx] optional	ExxxR ED1 ExxxZ	Resistor value in Ohms e.g. E470R = 470 Ohm Diode IN4007 = ED1 Zener diode e.g. E5V1Z = 5.1V
Series Module: [Sxxx] optional	SxxxR SD1 SxxxZ	Resistor value in Ohms e.g. S1K5R = 1.5K Ohm Diode IN4007 = SD1 Zener diode e.g. S5V1Z = 5.1V
Accessories:		
	SP65-0001-A2	Pole Mount Bracket Kit 2" St/St A2 (304)
	SP65-0001-A4	Pole Mount Bracket Kit 2" St/St A4 (316)
	SP65-0002-A2	Sunshade - St/St A2 (304)
	SP65-0002-A4	Sunshade - St/St A4 (316)